

when ordering use: CABINET CODE + W + H + D --- for example, an open wall cabinet 36Wx36Hx14D = CWO363614

wall cabinet doors come standard as flush style - doors with 1" overhang and no pull holes are also available, please specify when ordering
cabinets 12-24" wide have single doors - order as hinged left or right (HL or HR)
24"W has the option of single or double doors and all cabinets over 24" will have double doors

WALL CABINETS

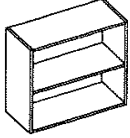

open wall cabinet - CWO
W - 12,16,18,20,24,28,30,32,36
H - 18,24,30,36,40
D - 14 (actual 13.125")

NOTE: 24" & 30"H include 1 adjustable shelf and 36" & 40" high include 2 adjustable shelves

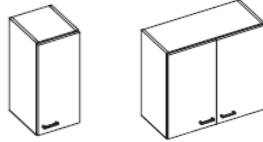

wall cabinet w/doors - CW
W - 12,16,18,20,24, 28,30,32,36
H - 18,24,30,36,40
D - 14

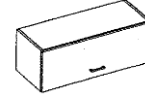

flipper door - CWFDF
W - 24,28,30,32,36
H - 15
D - 14

WALL CABINETS - FORM CABINETS & MAIL SLOTS

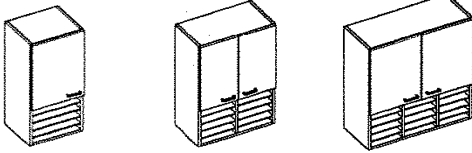

form cabinet - CWFDF
W - 12,16,18,20,24,28,30,32,36
H - 18,24,30,36,40
D - 14

NOTE: 12"-20"W = 1 bay | 24" & 28" = 2 bays | 30"-36"W = 3 bays

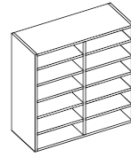

mail slots - CWMS323614
W - 32
H - 36
D - 14 (actual 13.125)
includes 12 slots

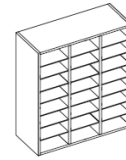

mail slots - CWMS324014
W - 32
H - 40
D - 14 (actual 13.125)
includes 24 slots

WALL CABINETS - SPECIALTY

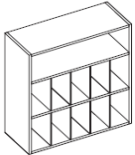

lateral storage - CWLSF323614
W - 32
H - 36
D - 14 (actual 13.125)
includes 10 slots

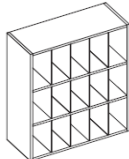

lateral storage - CWLSF324014
W - 32
H - 40
D - 14 (actual 13.125)
includes 15 slots

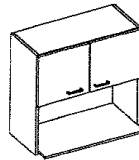

microwave - CWM
W - 24,28,30,32,36
H - 36,40
D - 14

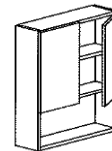

toilet - CTW243607
W - 24
H - 36
D - 7

TALL STORAGE CABINETS & LOCKERS

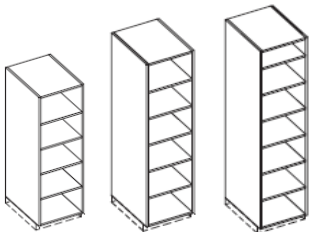

open cabinet - CCAB
W - 12,16,18,20,24,28,30,32,36
H - 61,71,80
D - 14,20,24 (actual 13.125, 19.125, 23.125)

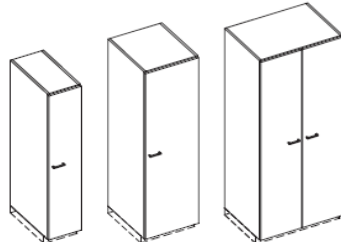

storage cabinet w/doors - CSC
W - 12,16,18,20,24,28,30,32,36
H - 61,71,80
D - 14,20,24

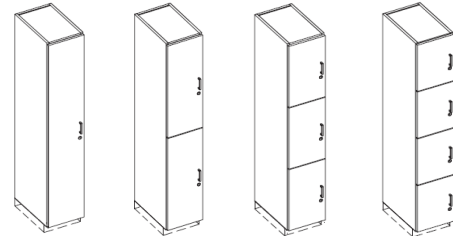

storage lockers - CSLKR
W - 12
H - 71
D - 20

NOTE: locks are standard on lockers
multiple doors will be key'd random, different key #'s

actual height of base cabinets is 5.5" less (4" allowed for base and 1.5" for countertop)

cabinets 12-24" wide have single doors - order as hinged left or right (HL or HR)

24"W has the option of single or double doors and all cabinets over 24" will have double doors

BASE CABINETS - 30" DESK, 34" ADA, 36" COUNTER HEIGHTS



open cabinet - CCAB

W - 12,16,18,20,24,28,30,32,36
H - 30,34,36 (actual 24.5,28.5,30.5)
D - 20,24 (actual 19.125,23.125)

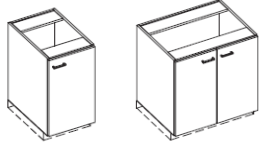

storage base - CSB

W - 12,16,18,20,24,28,30,32,36
H - 30,34,36 (actual 24.5,28.5,30.5)
D - 20,24

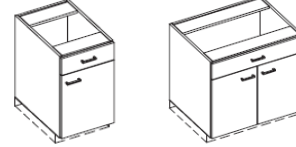

drawer storage base - CDSB

W - 12,16,18,20,24,28,30,32,36
H - 30,34,36 (actual 24.5,28.5,30.5)
D - 20,24

SINK BASE CABINETS - 34" ADA & 36" COUNTER HEIGHTS

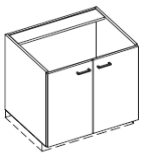

sink storage base - CSSB

W - 24,28,30,32,36
H - 34,36 (actual 28.5,30.5)
D - 20,24

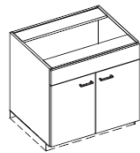

flase front sink base - CFSB

W - 24,28,30,32,36
H - 34,36 (actual 24.5,28.5,30.5)
D - 20,24



ADA sink base - CADAS

W - 24,30,32,36
H - 34,36 (actual 23)
D - 20,24

30"H DRAWER BASES & FILE BASES

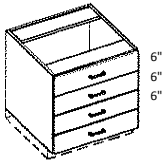

drawer base - CDB

W - 12,16,18,20,24,28,30,32
H - 30
D - 20,24

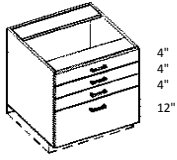

utility base - CUDB

W - 12,16,18,20,24,28,30,32
H - 30
D - 20,24

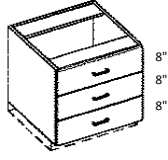

common base - CCDB

W - 12,16,18,20,24,28,30,32
H - 30
D - 20,24

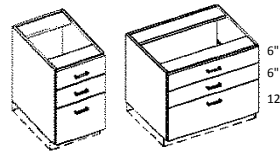

drawer file base - CDFB

W - 16,20,32
H - 30
D - 20,24

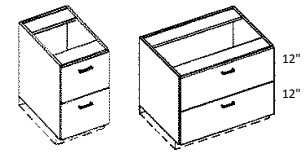

file base - CFB

W - 16,20,32
H - 30
D - 20,24

34"H ADA DRAWER BASES & FILE BASES

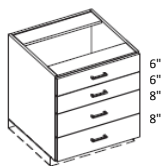

drawer base - CDB

W - 12,16,18,20,24,28,30,32,36
H - 34 (actual 28.5)
D - 20,24

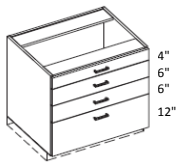

utility drawer base - CUDB

W - 12,16,18,20,24,28,30,32,36
H - 34 (actual 28.5)
D - 20,24



drawer file base - CDFB

W - 16,20,32
H - 34 (actual 28.5)
D - 20,24

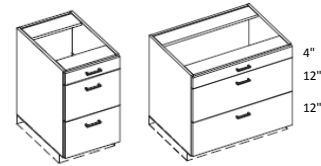

file base - CFB

W - 16,20,32
H - 34 (actual 28.5)
D - 20,24

36"H DRAWER BASES & FILE BASES

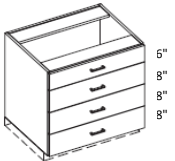

drawer base - CDB

W - 12,16,18,20,24,28,30,32,36
H - 36
D - 20,24



utility drawer base - CUDB

W - 12,16,18,20,24,28,30,32,36
H - 36 (actual 30.5)
D - 20,24

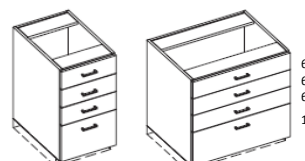

drawer file base - CDFB

W - 16,20,32
H - 36 (actual 30.5)
D - 20,24

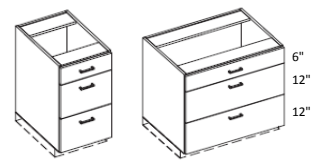

file base - CFB

W - 16,20,32
H - 36 (actual 30.5)
D - 20,24

HANGING UNITS



pencil drawer - CPD
W - 16,18,20,24,30,32
H - 4
D - 20,24



prescription desk - CRX
W - 24,30,32
H - 16
D - 16,20,24



angle bracket - C18ANG
W - 4
H - 18
D - 18



coat shelf - COAT
W - 30,32,36,42,48
H - 8
D - 16

4" CABINET BASES

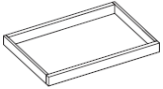

plinth base w/levelers - CPL
W - 12,16,18,20,24,30,32,36
H - 4
D - 20,24 (actual 17.25, 21.25)
NOTE: RTA & all 4 sides are laminated/finished

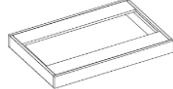

finished base - CBASE
W - specify exact length in inches
H - 4
D - 20,24 (actual 17.25, 21.25)
NOTE: 1" or 3" tails available - please specify tail right, tail left or both & on finished base, specify finished sides

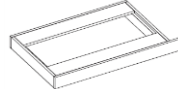

rough/unfinished base - ROUGHBASE
W - specify exact length in inches
H - 4
D - 20,24 (actual 17.25, 21.25)
NOTE: 1" or 3" tails available - please specify tail right, tail left or both & on finished base, specify finished sides

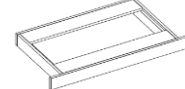
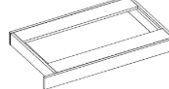

PRE-CUT FILLERS



wall fillers - CWFILLER
W - 1,3
H - 18,24,30,36,40
D - 13

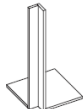

3x3 wall corner filler - CWCORNFILLER
W - 3
H - 18,24,30,36,40
D - 13



base fillers - CFILLER
W - 1,3,5,10
H - 30,34,36,61,71,80,96
D - 3/4



3x3 base corner filler - CCRNFILLER
W - 3
H - 30,34,36,61,71,80
D - 3

SHELVING

shelves are standard at 3/4" thick but are also available 1.125" thick, please specify when ordering



open shelf - COS
W - 120*
D - 12



adjustable cabinet shelf - CSH
W - 12,16,18,20,24,28,30,32,36
D - 14,20,24 (actual 12,18,22)



fixed cabinet shelf - CFSH
W - 12,16,18,20,24,28,30,32,36
D - 14,20,24 (actual 12,18,22)



sliding cabinet shelf - CSS*
W - 12,16,18,20,24,28,30,32,36
D - 14,20,24 (actual 12,18,22)

*or by the linear inch, up to 120

NOTE: width of shelf noted is cabinet width, actual shelf size is 1.5" less

*sliding shelves include slides - special hinges will be needed if used within a cabinet with doors

Product features include:

PVC edge banding – Vogel edge banding is of the highest quality PVC. For all standard laminate finishes, the edge banding will perfectly match all surfaces

Matching interior surfaces – interiors match the exterior surfaces for a consistent appearance

Hinges – hinges are 120-degree and six-way adjustable to maintain consistent and equal spacing between doors

Full extension glides – drawers have full extension, over-travel glides to allow for full access to the interior of the drawer

File management system – all designated file drawers have an integrated, metal hanging file system to allow for front to back or side to side filing

Locks – single and gang locks are available with keyed alike or keyed random options. Cores are interchangeable as personnel changes

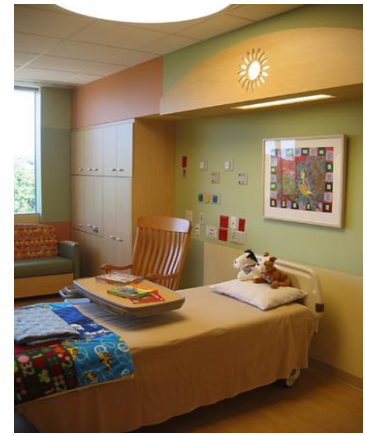

functional furniture... by design!



VOGEL | **CCS**[™]

modernspace - techlinerockford COMMERCIAL CABINETS SYSTEM



What is **VOGEL** | **CCS**?

Vogel Commercial Cabinetry System is a laminate cabinet line, constructed using AWI & AWS standards for both modular and custom casework. Vogel CCS is a product of modernspace - techlinerockford and is manufactured by Vogel Wood Products in Monona, Wisconsin. Our casework is a completely finished unit, providing the benefit of repurposing as needs and functions change. At modernspace, we can help you design your space and will provide you with floor plans and elevations to review, free of charge. Expert design combined with state-of-the-art manufacturing defines our casework's quality and our reputation in the marketplace, and we back this up with a 10 year warranty.

